





****FURNISHED PROPERTY****

NEXA Properties are delighted to be offering this beautiful two bedroom terraced house situated on Wainscott Road, Southsea.

The property opens up into a spacious reception room with feature wall and laminate flooring, this leads on to a modern kitchen with appliances which include oven/hob, washing machine, tumble dryer, dishwasher and a large fridge/freezer.

Upstairs offers two bedrooms and a stylish bathroom suite with shower over bath. To the back of the property is an east facing garden with already fitted decking.

Other benefits include good quality furnishings, great style carpets and double glazing throughout.

Would suit a professional couple or small family.

Contact NEXA to arrange a viewing.

- BEAUTIFUL TERRACED HOUSE
- FULLY FURNISHED
- STYLISH BATHROOM
- PERFECT FOR A COUPLE
- AVAILABLE MARCH
- WITHIN WALKING DISTANCE TO SOUTHSEA BEACH
- MODERN KITCHEN
- WHITE GOODS INCLUDED



Wainscott Road, Southsea, PO4 9nn

Approximate Gross Internal Area = 66.7 sq m / 718 sq ft

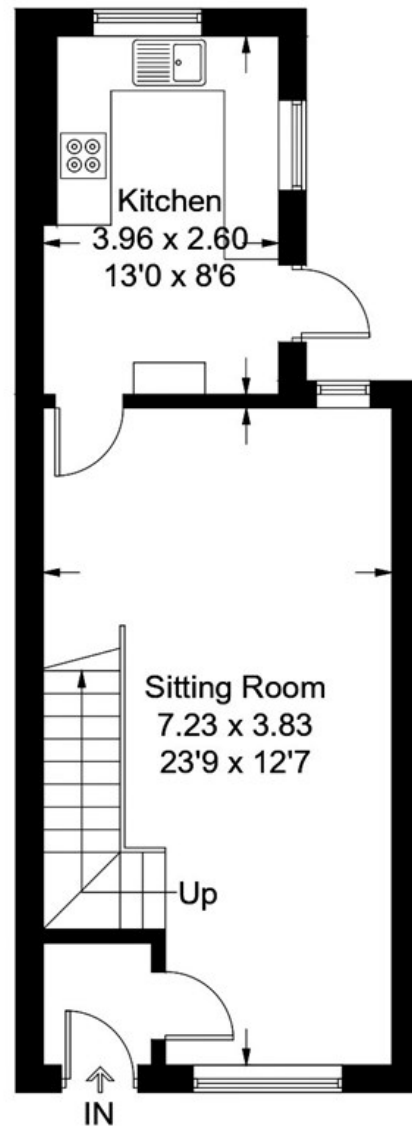

Ground Floor

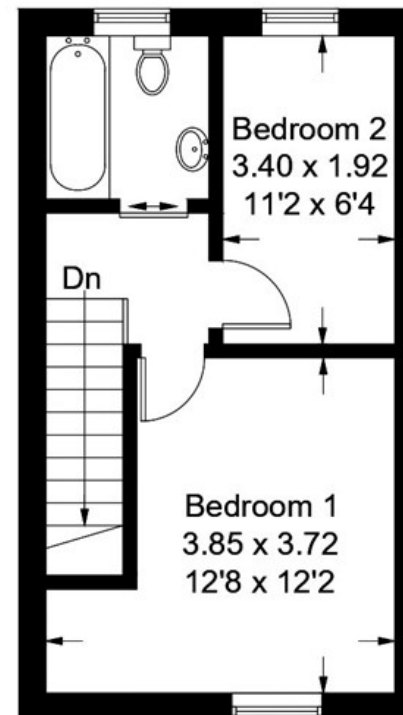

First Floor

This plan is for layout guidance only. Not drawn to scale unless stated. Windows and door openings are approximate. Whilst every care is taken in the preparation of this plan, please check all dimensions, shapes and compass bearings before making any decisions reliant upon them. (ID649915)